

Carriage replacement Procedure

Unplug the power and data cable from the back of the machine.



Caution: DO NOT power the machine on before completing all the steps in this procedure. Failure to do so will result in permanent damage to the electrical components of the machine.

① Removing the bottom cover

Carefully place the machine on a sturdy table on it's back. Remove the machine from the stand or cradle if you have one.

Remove the screws on the bottom cover.

Unplug the fan connector from the board and remove the bottom cover.

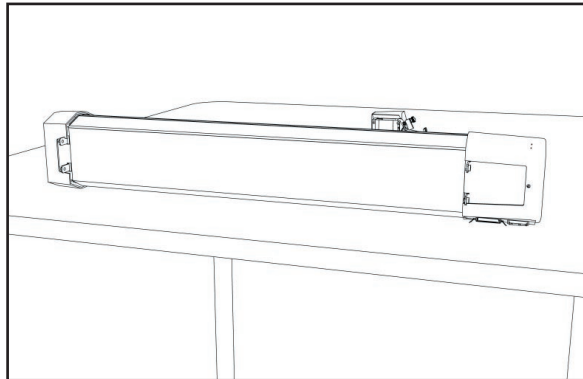

② Unplugging the logic board

Carefully unplug all the connectors shown from the logic board.

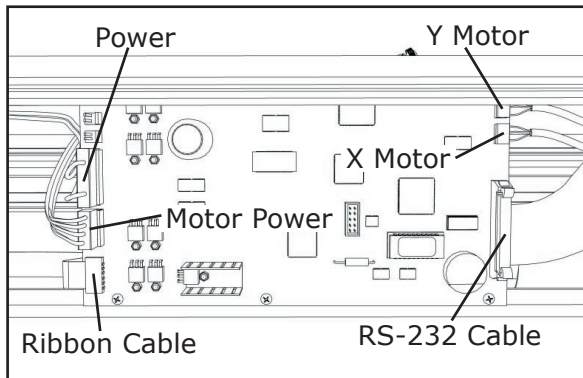

③ Removing the board

Unscrew the three (3) Silver Phillips screws holding the board in the machine.

Carefully remove the board from the machine.

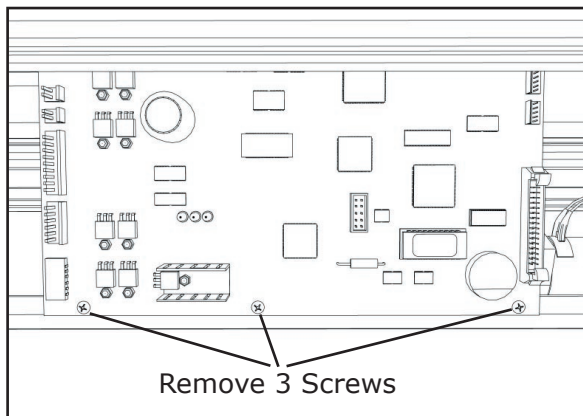

④ Installing the new board

Carefully place the new logic board into the machine body. Make sure you place the top edge into the groove inside the body of the machine.

Install and tighten the 3 screws that mount the board in the machine. DO NOT overtighten.

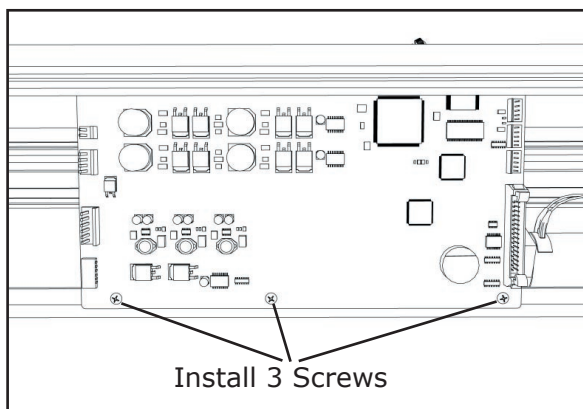

HOLINE

14140 NE 200th St
Woodinville, WA 98072
PH: (425) 398-8282
FX: (425) 398-8383

Tools Required:

Phillips Screwdriver
9/64" Allen Wrench

Applies to:

Smartrac
100 Cutter
Contour Cutter



Caution: Always observe anti-static procedures. Failure to properly ground yourself to metal before handling the board can cause permanent damage. Use the provided wrist-strap to properly ground yourself to the machine.

P/N: 109309 R0

⑤ Connecting the new board

Carefully plug in all the connectors to the new board as shown. Leave the 'power supply' connector unplugged for now.

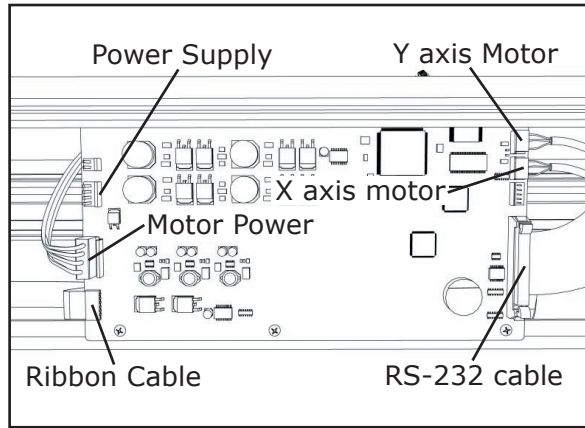

⑥ Replacing the power cable

Unplug the power supply cable (shown) from the power supply.

Cut the tyrraps holding the cable and remove the cable from the machine.

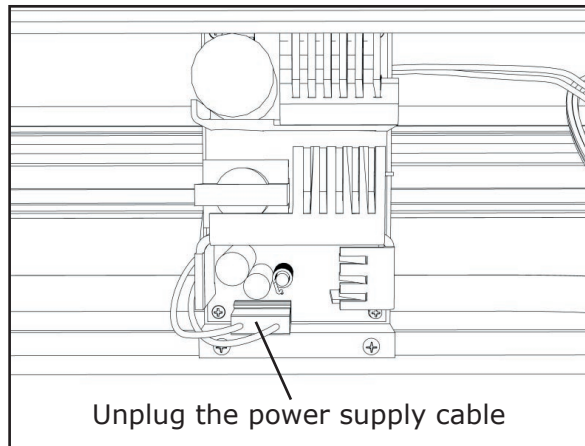

⑦ Install the new cable

Plug in the new power supply cable to the power supply and the new logic board.

Plug in the fan connector to the board and install the bottom cover.

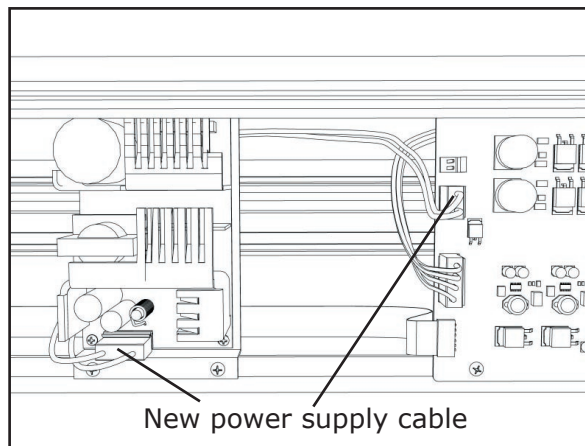

⑧ Preparing for carriage replacement

Put the machine back in normal operating position.

DO NOT install the machine to the stand or cradle yet.



DO NOT power on the machine yet.

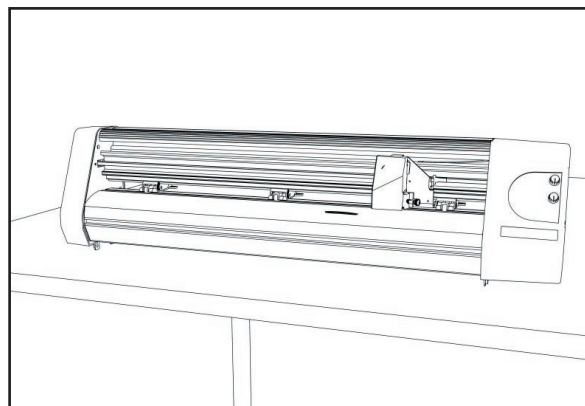

9 Removing the left end cover

Remove the left side cover of the machine. Locate the 2 black Phillips screws shown.

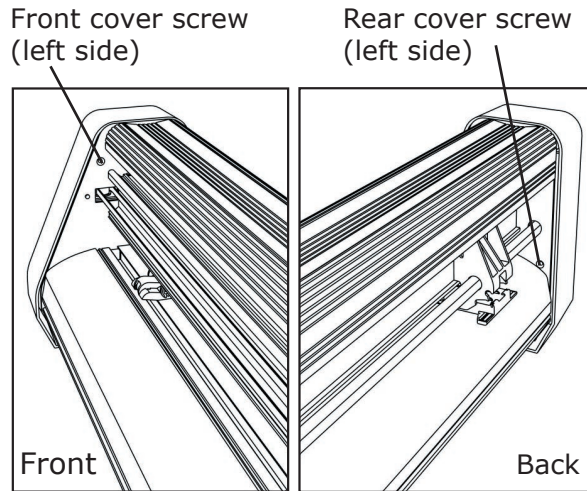

10 Loosen the belt tensioner

Mark the screw on the Y axis belt tensioner with "White-Out" to mark the position of the screw before you loosen it. Loosen the 9/64" allen screw on the belt tensioner until the the bracket is flat against the end plate. Do not remove the screw.

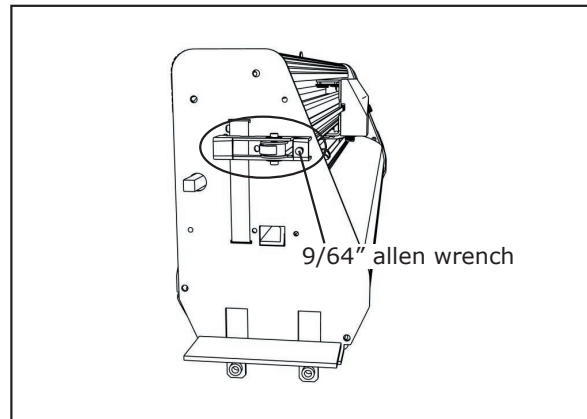

11 Removing the carriage cover

Remove the carriage cover screws shown and remove the cover from the machine.

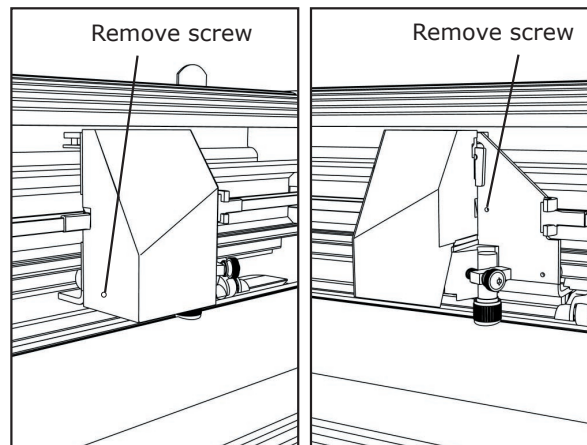

12 Unclip the belts

Grasp one of the metal "T"-connectors on the end of the Y Axis belt and pull it toward the center of the carriage until it pops free. Make sure that the tensioner assembly is not tangled in the belt. Remove the other end of the belt from the carriage.

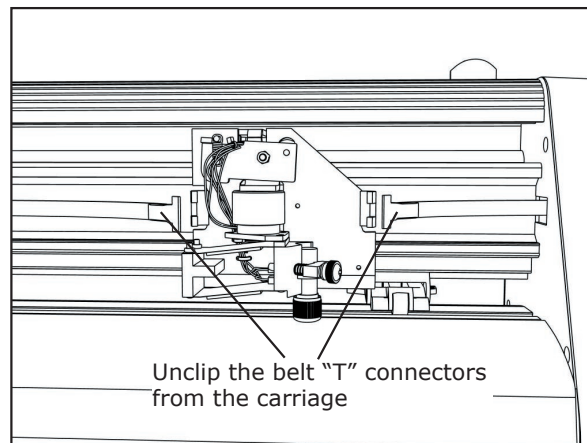

13 Push down on the carriage

Remove the carriage from the machine by pushing down on the belt attachment fingers.

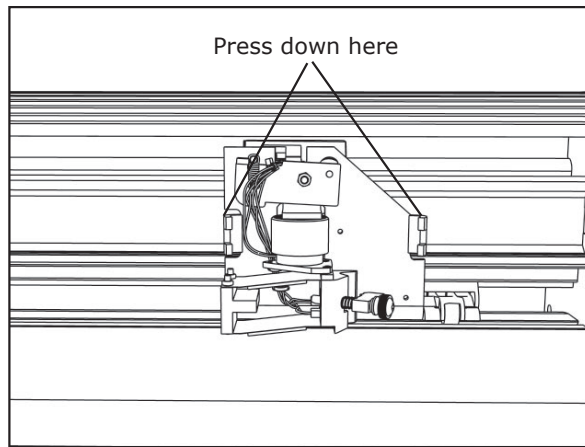

14 Rotate the carriage

While pushing down, pull the bottom of the carriage assembly toward the front of the machine.

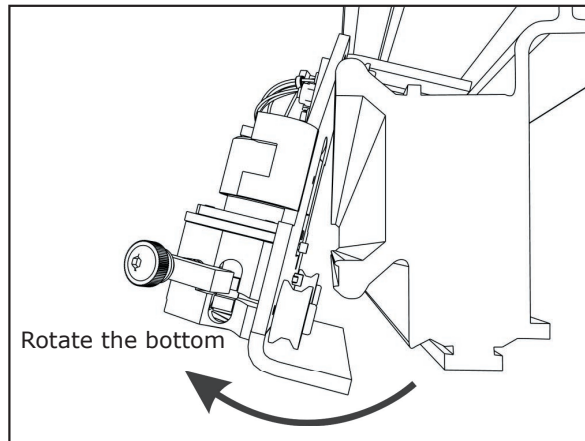

15 Remove the carriage

Pull the carriage slowly toward the front of the machine being sure not to damage the flex cable.

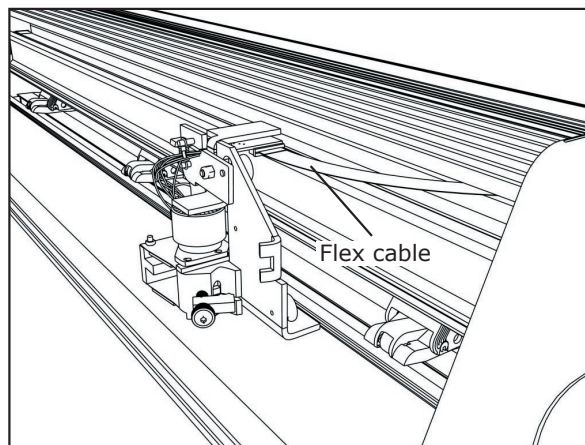

16 Unplug the ribbon cable

Disconnect the flex cable from the carriage by pulling the flex cable from the socket. The flex cable is fragile so be very careful when loosening it.

Follow the procedure in reverse order to install the new carriage.

Plug the power cable into the back of the machine and power on. Test the machine.

