

Carriage replacement Procedure

Unplug the power and data cable from the back of the machine.

① Removing the left end cover

Remove the left side cover of the machine. Locate the 2 black Phillips screws shown.

Front cover screw
(left side)

Rear cover screw
(left side)

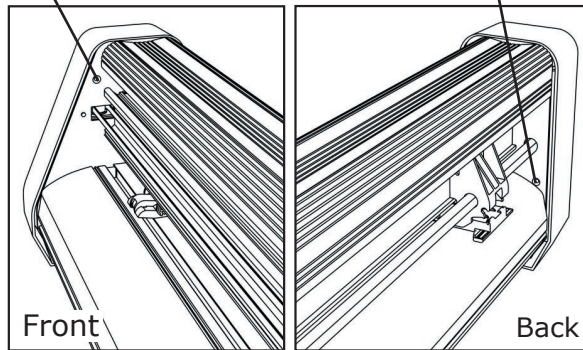

② Loosen the belt tensioner

Mark the screw on the Y axis belt tensioner with "White-Out" to mark the position of the screw before you loosen it. Loosen the 9/64" allen screw on the belt tensioner until the the bracket is flat against the end plate. Do not remove the screw.

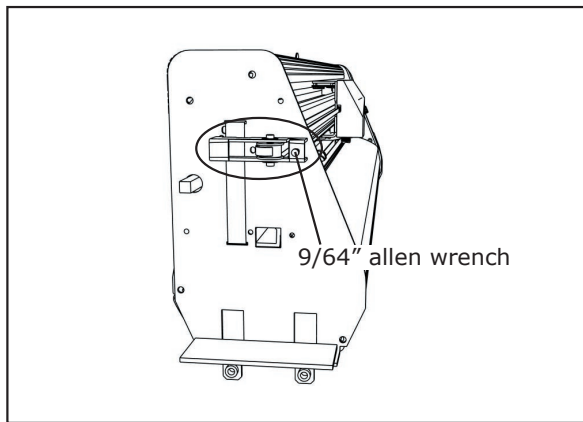

③ Removing the carriage cover

Remove the carriage cover screws shown and remove the cover from the machine.

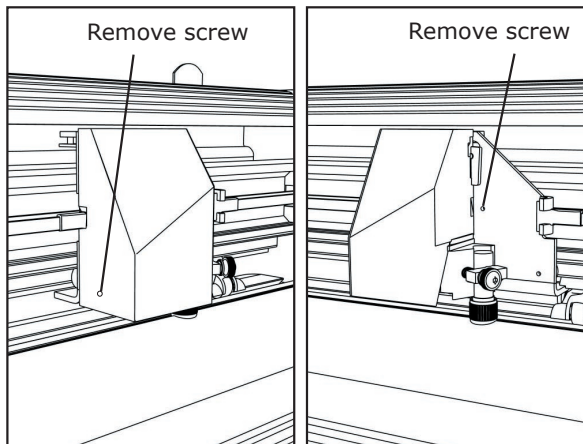

④ Unclip the belts

Grasp one of the metal "T"-connectors on the end of the Y Axis belt and pull it toward the center of the carriage until it pops free. Make sure that the tensioner assembly is not tangled in the belt. Remove the other end of the belt from the carriage.

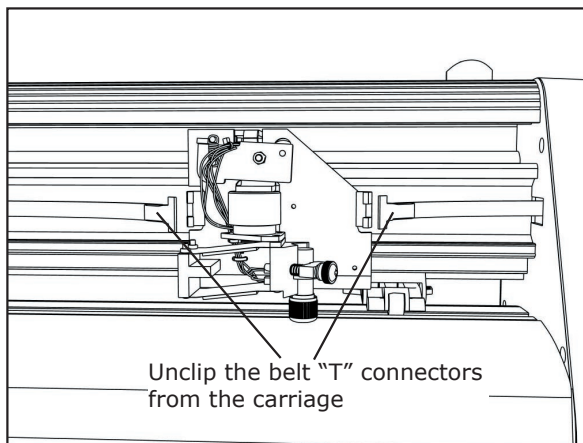

HOLINE

14140 NE 200th St
Woodinville, WA 98072
PH: (425) 398-8282
FX: (425) 398-8383

Tools Required:
Phillips Screwdriver
9/64" Allen Wrench

Applies to:
Smartrac
100 Cutter
Contour Cutter

5 Push down on the carriage

Note: Make sure the blade holder is removed from the carriage.

Remove the carriage from the machine by pushing down on the belt attachment fingers.

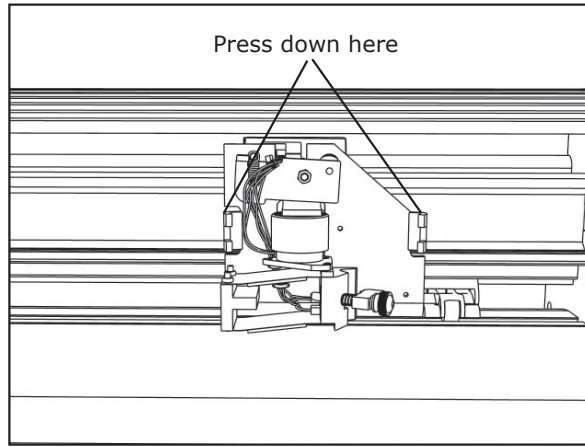

6 Rotate the carriage

While pushing down, pull the bottom of the carriage assembly toward the front of the machine.

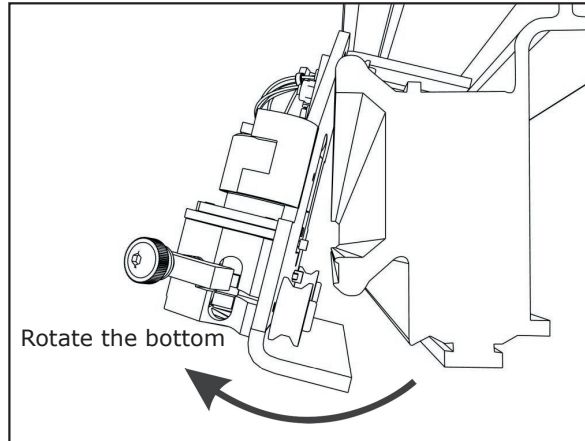

7 Remove the carriage

Pull the carriage slowly toward the front of the machine being sure not to damage the flex cable.

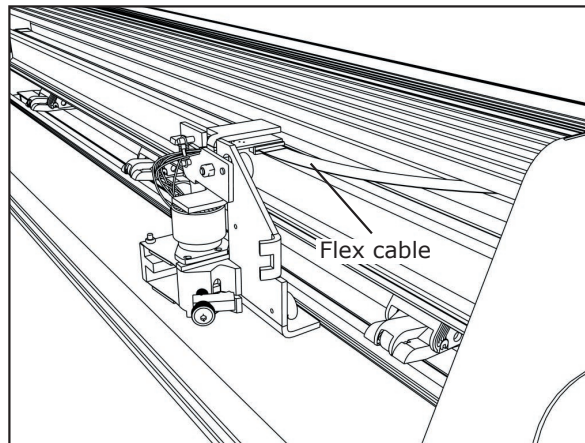

8 Unplug the ribbon cable

Disconnect the flex cable from the carriage by pulling the flex cable from the socket. The flex cable is fragile so be very careful when loosening it.

Follow the procedure in reverse order to install the new carriage.

Plug the power cable into the back of the machine and power on. Test the machine.

If everything works good reinstall the left cover on the machine.

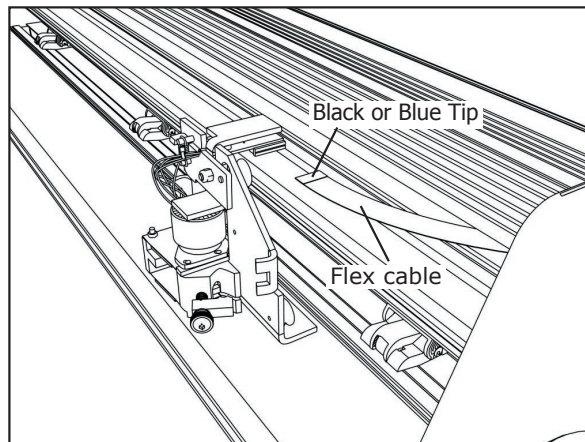

14140 NE 200th St
Woodinville, WA 98072
PH: (425) 398-8282
FX: (425) 398-8383

Note:
If problems arise
contact Ioline Tech
Support.

P/N: 106911 R1